

DESCRIPTION

The Paralux III Series features recessed aesthetics and the latest in energy efficient technology. The luminaire incorporates a nominal 3" deep precision cell louver into a 4-3/4" deep para-contoured fixture housing. This combination creates a total high performance parabolic optical assembly for optimum performance. The series is compatible with all of today's popular ceiling systems and is available with a number of options and accessories for application versatility. The high performance luminaire is designed to offer maximum efficiency and performance for today's unique interior specifications. The Paralux III series is an excellent choice for commercial office spaces, schools, hospitals or retail merchandising areas.

SPECIFICATION FEATURES

Construction

4-3/4" deep, para-contoured housing, die formed of code gauge, prime cold rolled steel. Die embossed housing has full length die formed stiffeners for added strength. Contoured ballast/wireway cover is easily removed. Die formed captive lampholder bracket fully encloses lampholder wiring permitting easy lampholder replacement. Heavy gauge end plates are securely attached with interlocking tabs and screws. Four auxiliary fixture end suspension points provided. KOs for continuous row wiring. End plates have integral Grid-Lock feature for safety and convenience.

Electrical**

Ballast are CBM/ETL Class "P" and are positively secured by mounting bolts. Pressure lock lampholders. UL/CUL listed. Suitable for damp locations.

Finish

Lighting grade, baked white enamel finish. Multistage, iron phosphate pretreatment ensures maximum bonding and rust inhibition.

Hinging/Latching

Positive spring loaded, self locking, steel latches. Safety lock T-hinges allow hinging and latching from either side.

Louver

Die formed of low iridescent, vertical grain anodized aluminum. Finish is Anodic oxide coating. Accurate precision parabolic cells are held in place with interlocking feature. True-cut mitered corners. Black reveal with integral mechanical light seal around entire perimeter of louver. Louver protected from construction contaminants by polyethylene cover.

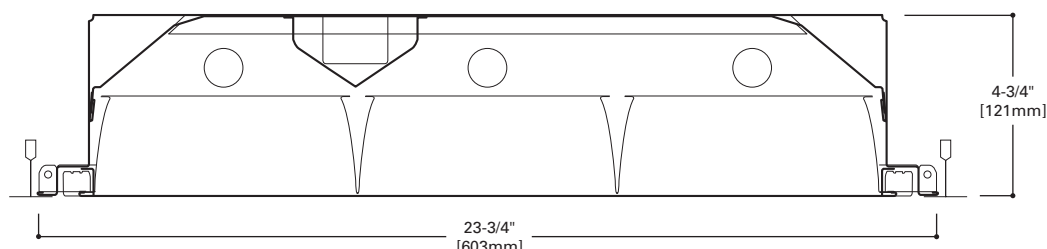

2EP3GX
317

9 Cell

**2' X 2' PARABOLIC
3 T8 LAMPS
SEMI-SPECULAR, SPECULAR
OR WHITE PAINTED LOUVER**

Paralux III
Recessed Static or Air
Supply Troffer

MOUNTING DATA

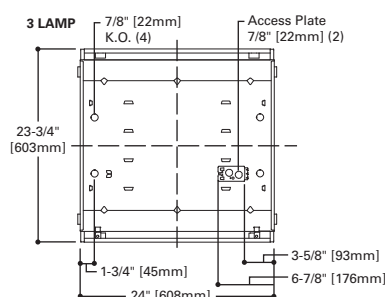

LAMP CONFIGURATIONS

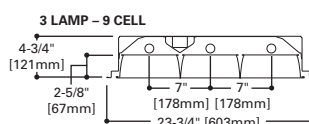

CEILING COMPATIBILITY

G	G	G	F	MZ	Ceiling Type	Trim Type
Grid/Lay-in Standard	Concealed T	Slot Grid	Aluminum Flange Trim With Supporting Swing Gates	Modular Trim With Supporting Swing Gates	Exposed Grid	G
					Concealed T	G
					Slot Grid	G
					Flange	F
					Concealed "T" or "Z"	MZ
					Metal Pan	MZ
					(Verify compatibility/ consult factory.)	

ENERGY DATA

Input Watts:
EB Ballast & STD Lamps
317 (56)

Luminaire Efficacy Rating
LER = FP-57
Catalog Number: 2EP3GX-317
Yearly Cost of 1000 lumens,
3000 hrs at .08 KWH = \$4.24

**Reference the lamp/ballast data in the Technical Section for specific lamp/ballast requirements.

LAMPS CONTAIN MERCURY. DISPOSE ACCORDING TO LOCAL, STATE OR FEDERAL LAWS

LINEAR DISCONNECT

Safe and convenient means of disconnecting power.

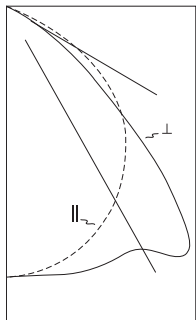

PHOTOMETRICS

2EP3GX-317S331-PAF
 Electronic Ballast

 (3) F17T8/TL841 Lamps
 1400 Lumens

 Spacing criterion:
 (II) 1.2 x mounting
 height, (⊥) 1.6 x
 mounting height
 Efficiency 71.3%

 Test Report:
 ITL52928

LER = FP-57

 Yearly Cost of 1000
 lumens, 3000 hrs at
 .08 KWH = \$4.24

Coefficients of Utilization

Effective floor cavity reflectance										20%											
rc	80%				70%				50%				30%				10%				0%
rw	70	50	30	10	70	50	30	10	50	30	10	50	30	10	50	30	10	0			
RCR																					
0	85	85	85	85	83	83	83	83	79	79	79	76	76	76	73	73	73	71			
1	79	77	74	72	78	75	73	71	72	70	69	69	68	67	67	66	65	63			
2	74	69	65	61	72	67	64	61	65	62	59	63	60	58	61	59	57	55			
3	68	62	57	53	66	60	56	52	58	55	51	57	53	51	55	52	50	48			
4	63	55	50	46	61	54	49	45	53	48	45	51	47	44	50	46	44	42			
5	58	50	44	40	57	49	44	40	48	43	39	46	42	39	45	41	39	37			
6	54	45	39	35	52	44	39	35	43	38	35	42	38	34	41	37	34	33			
7	50	41	35	31	49	40	35	31	39	35	31	38	34	31	38	34	31	29			
8	46	38	32	28	45	37	32	28	36	31	28	35	31	28	34	30	27	26			
9	43	34	29	25	42	34	29	25	33	28	25	32	28	25	32	28	25	24			
10	41	32	26	23	40	31	26	23	31	26	23	30	26	23	29	25	23	21			

Zonal Lumen Summary

Zone	Lumens	%Lamp	%Fixture
0-30	1000	23.8	33.4
0-40	1708	40.7	57.0
0-60	2832	67.4	95.6
0-90	2995	71.3	100.0
0-180	2995	71.3	100.0

Typical VCP Percentages

Room Size (Ft.)	Height Along		Height Across	
	8.5'	10.0'	8.5'	10.0'
20 x 20	79	75	84	80
30 x 30	84	81	88	84
30 x 60	87	83	89	86
60 x 30	86	83	90	87
60 x 60	88	86	91	88

Candela

Angle	Along II	45°	Across ⊥
0	1234	1234	1234
5	1227	1228	1235
10	1204	1219	1243
15	1173	1209	1257
20	1128	1194	1266
25	1077	1168	1262
30	1019	1134	1277
35	949	1090	1402
40	865	1062	1296
45	766	1029	910
50	654	816	538
55	525	498	342
60	363	264	211
65	158	124	85
70	48	45	36
75	23	20	19
80	10	9	9
85	3	3	3
90	0	0	0

ORDERING INFORMATION

SAMPLE NUMBER: 2EP3GX-317S331-UNV-EB81-U

Rating Blank= Standard ATW-SW4= Chicago Rated	Number of Lamps 3=3 Lamps ⁽³⁾	Voltage ⁽⁴⁾ 120V=120 Volt 277V=277 Volt 347V=347 Volt UNV=Universal Voltage 120-277 ⁽⁶⁾	Ballast Type EB8 =T8 Electronic Start. Total Harmonic Distortion < 10% No. of Ballast 1, 2 or 3 EB8 /PLUS =T8 Electronic Start. Total Harmonic Distortion < 10% High Ballast Factor >1.15 No. of Ballast 1, 2 or 3 ER8 =T8 Electronic Program Rapid Start. Total Harmonic Distortion < 10% No. of Ballast 1, 2 or 3	Options PAF =Painted After Fabrication REP =Riveted Endplates	Packaging U =Unit Pack PAL =Job Pack, out of carton PALC =Job Pack, in carton
HR =Heat Removal ⁽¹⁾ Width 2=2' Width EP =Paralux Louver 3 =3" Louver Depth	Wattage (Length) 17=17W T8 (24") Louver Color S =Silver W =White	Options GL =Single Element Fuse GM =Double Element Fuse WTR =White Reveal Lamps =Lamps Installed (refer to lamp ordering options) Flex =Flex Installed (Reference Flex ordering information) EL =Emergency Installed ⁽⁶⁾			
Trim Type G =Grid/Lay-in (Standard) G =Concealed T/Slot Grid ⁽⁷⁾ F =Aluminum Flange Trim ⁽⁸⁾ MZ =Modular Trim	Cell Configuration 33=3 Rows of 3, 9 Cell Louver Finish I =Semi-Specular/Haze (Low Iridescent) Standard (Silver Only) MI =Specular/Mirrored (Low Iridescent) (Silver Only) P =Painted (White only)	Option - Aluminum Flange Trim ⁽⁸⁾ Blank =SW (Single White) Type Color 'S' Single 'N' Natural 'R' In Row 'W' White 'E' End of Row			
AX =Air Supply Floating Louver X =Blank Side/Floating Louver - Non-Air Supply (Omit A) AVX =Air Supply Floating Louver with Directional Air Vane (Add V)					

ACCESSORIES

 EQ-CLIP-U=T-BAR Safety Earthquake Clips⁽²⁾

NOTES: ⁽¹⁾ Integral end plate grid lock feature not available in heat removal. ⁽²⁾ An EQ Grid Clip is recommended for all 9/16" ceiling systems. Four required per fixture. ⁽³⁾ Standard off-center ballast on 3-lamp fixtures. ⁽⁴⁾ Products also available in non-US voltages and frequencies for international markets. ⁽⁵⁾ Not available when specifying emergencies, voltage must be specific. ⁽⁶⁾ Fixtures equipped with "EL" option may require a 5-1/2" housing depth. If installing in field, must use low profile battery pack. ⁽⁷⁾ Louver is recessed by 5/16" in Concealed T or Slot Grid T. ⁽⁸⁾ Specify row configuration, type in catalog number when ordering complete fixture.

For complete product data, reference the Fluorescent Specification binder. Specifications & dimensions subject to change without notice. Consult your Cooper Lighting Representative for availability and ordering information.

SHIPPING DATA

Catalog No.	Wt.
2EP3GX-317S331	28 lbs.